



JOHN DEAN
Estate Agents
Chartered Surveyors

Tel: 020 8673 8855 Fax: 020 8673 4879
email: info@johndean.co.uk

189 Balham High Road, London SW12 9BA



Ribblesdale Road SW16 6SE

A large first floor studio flat with a separate kitchen and bathroom/WC. Located between Streatham Common station and Tooting Bec in a sought after residential area known as Furzedown. Tooting Bec common is close by.

£210 pw / £910 pcm – Fees apply

**RIBBLESDALE ROAD
LONDON SW16**

**APPROXIMATE INTERNAL FLOOR AREA
421 SQ.FT. / 39.1 SQ.M.**

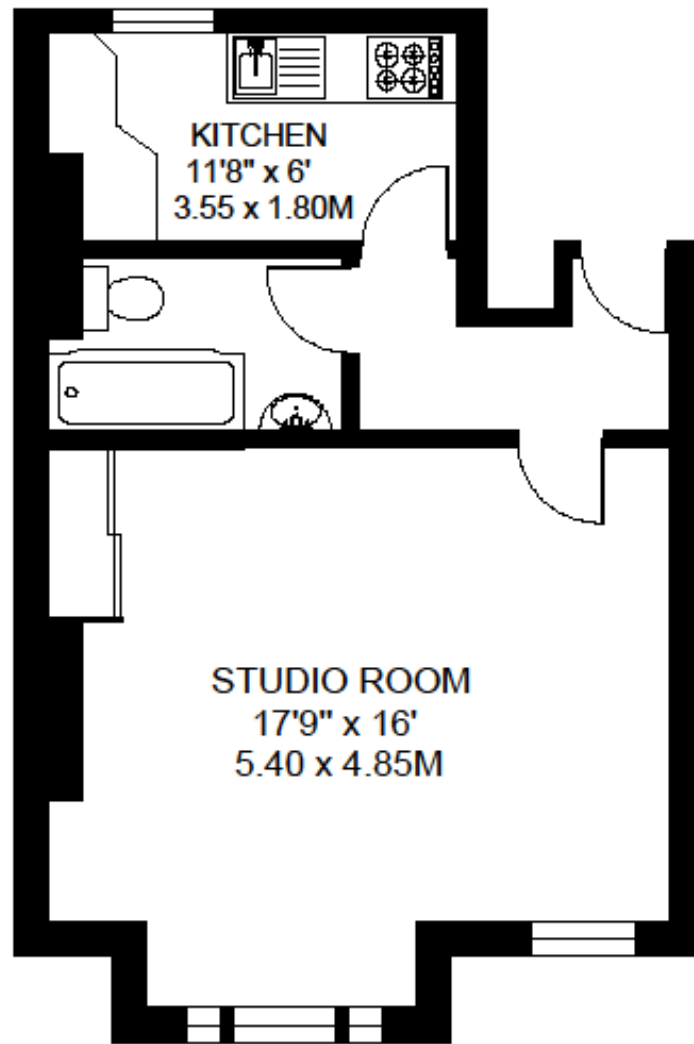

FIRST FLOOR

© FLOORPLAN PRODUCED FOR JOHN G. DEAN & Co. BY FLOORPLANNERS 07801 228850
ALL MEASUREMENTS ARE MAXIMUM, AND INCLUDE WINDOW BAYS AND WARDROBES WHERE APPLICABLE

Energy Efficiency Rating		Current	Potential	Environmental Impact (CO ₂) Rating		Current	Potential
Very energy efficient - lower running costs	(92 plus)	A		Very environmentally friendly - lower CO ₂ emissions	(92 plus)	A	
	(81-91)	B			(81-91)	B	
	(69-80)	C			(69-80)	C	
	(55-68)	D	64		(55-68)	D	
	(39-54)	E	64		(39-54)	E	57
	(21-38)	F			(21-38)	F	
Not energy efficient - higher running costs	(1-20)	G		Not environmentally friendly - higher CO ₂ emissions	(1-20)	G	
England & Wales			EU Directive 2002/91/EC	England & Wales			EU Directive 2002/91/EC