



**JOHN DEAN**  
Estate Agents  
Chartered Surveyors

Tel: 020 8673 8855 Fax: 020 8673 4879  
email: [info@johndean.co.uk](mailto:info@johndean.co.uk)

189 Balham High Road, London SW12 9BA



## **BALHAM**

This unmodernised, one bedroom, fourth floor flat provides a different layout compared with the average one bedroom flat in this landmark Art Deco building. The flat also benefits from double glazing and great potential to improve as well as the very rare feature of a balcony which provides impressive roof top views.

**£415,000 L/H**

**DUCANE COURT  
LONDON SW17**

APPROXIMATE INTERNAL FLOOR AREA  
**504 SQ.FT. / 46.8 SQ.M.**

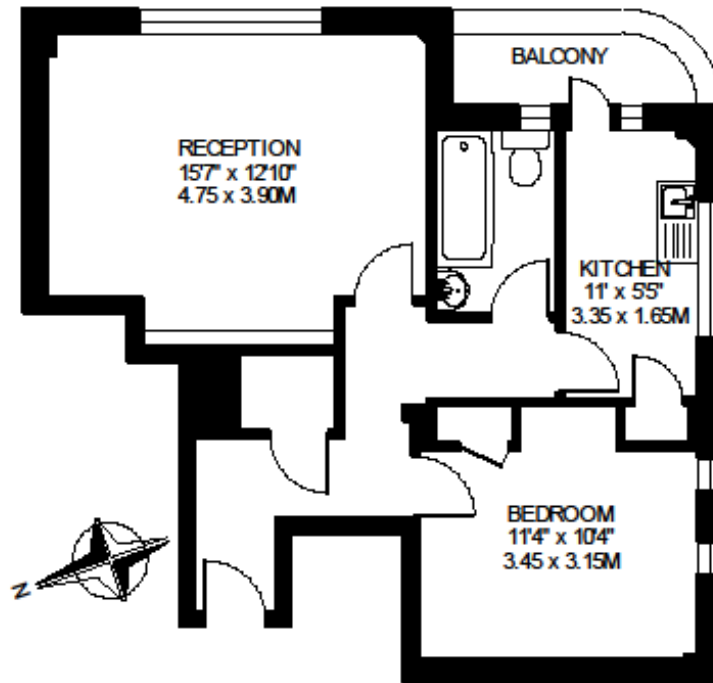

**FOURTH FLOOR**

© FLOORPLAN PRODUCED FOR JOHN G. DEAN & Co. BY FLOORPLANNERS 07801 228850  
ALL MEASUREMENTS ARE MAXIMUM, AND INCLUDE WINDOW BAYS AND WARDROBES WHERE APPLICABLE

