



**JOHN DEAN**  
Estate Agents  
Chartered Surveyors

Tel: 020 8673 8855 Fax: 020 8673 4879  
email: [info@johndean.co.uk](mailto:info@johndean.co.uk)

189 Balham High Road, London SW12 9BA



## **BALHAM/TOOTING BEC**

A well presented one bedroom first floor flat with the bonus of an allocated parking bay. Great position close to Northern Line tube and mainline train services at Balham station as well as many shops and restaurants on Balham High Road.

**£330 pw / £1430 pcm – Fees apply**

ASHDOWN WAY  
LONDON SW17

APPROXIMATE INTERNAL FLOOR AREA  
498 SQ.FT. / 46.2 SQ.M.

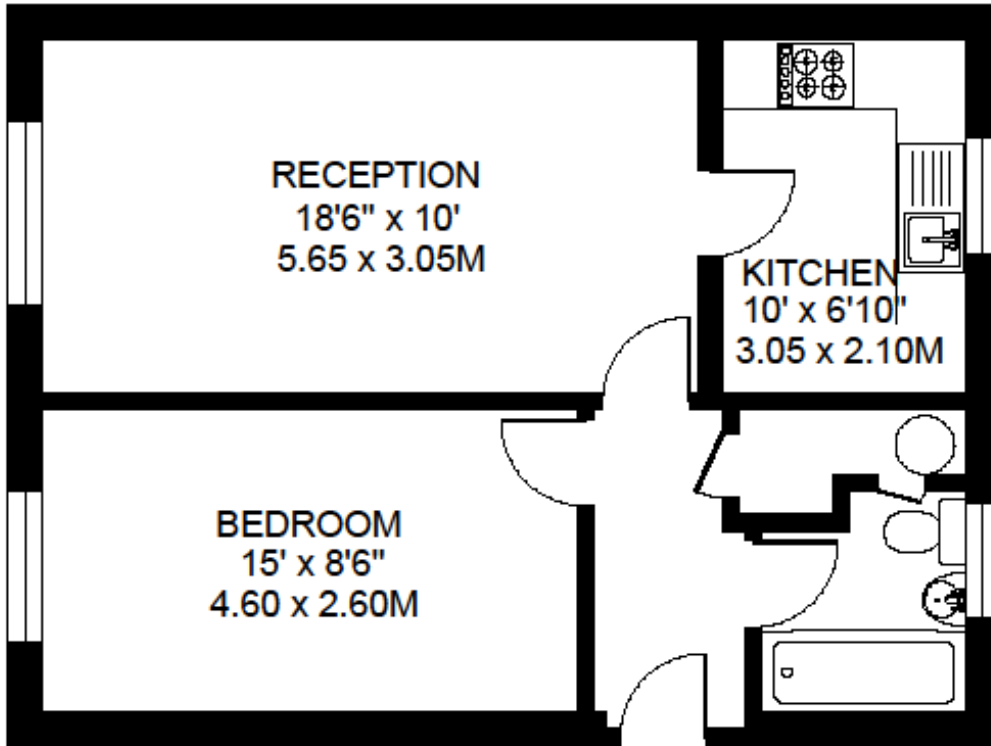

FIRST FLOOR

© FLOORPLAN PRODUCED FOR JOHN G. DEAN & Co. BY FLOORPLANNERS 07801 228850  
ALL MEASUREMENTS ARE MAXIMUM, AND INCLUDE WINDOW BAYS AND WARDROBES WHERE APPLICABLE

